

Rough Opening:  
22-3/8" (w) x 48-3/8" (h)

Actual Opening:  
22" (w) x 48" (h)

Note: Aluminum framing is not bullet resistant rated.

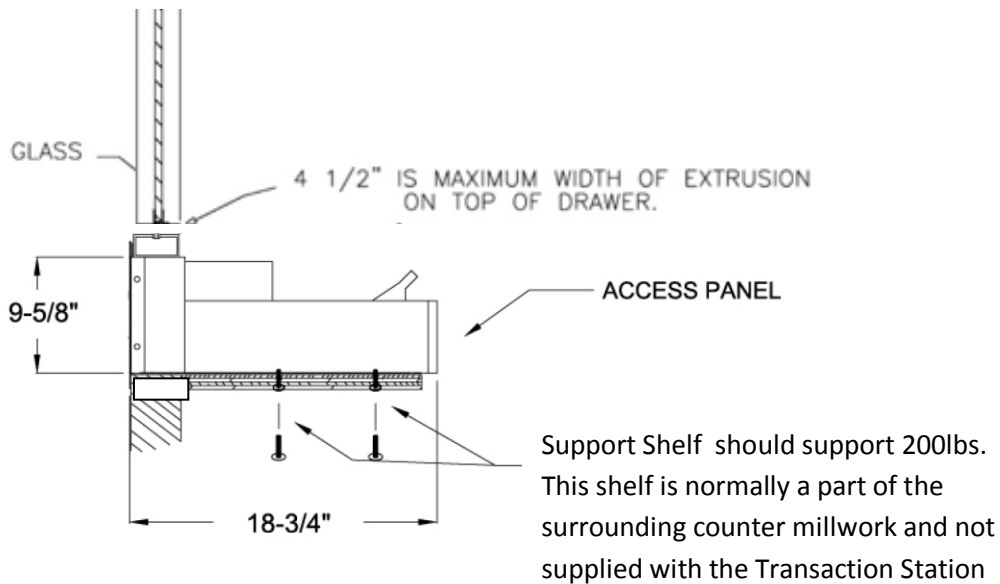
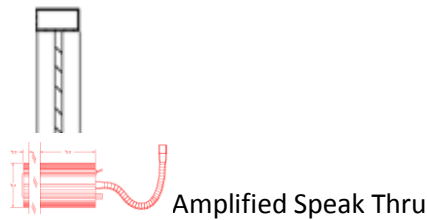
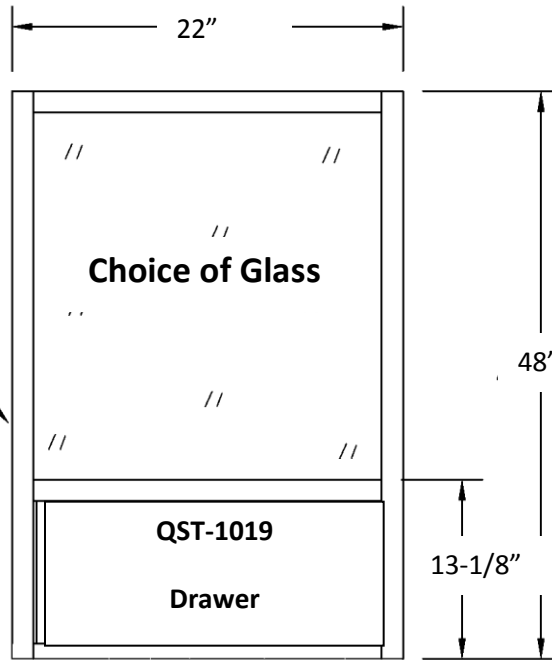

NOTE: THIS DRAWING EMBODIES A CONFIDENTIAL PROPRIETARY DESIGN ORIGINATED AND OWNED BY QUIKSERV CORP., AND IS SUBMITTED UNDER A CONFIDENTIAL RELATIONSHIP. ALL PATENT, MANUFACTURING, SALE RIGHTS REGARDING THE SAME ARE RESERVED EXCEPT TO THE EXTENT RIGHTS ARE EXPRESSLY GRANTED TO OTHERS. THE RECIPIENT AGREES BY ACCEPTING THESE DRAWINGS NOT TO SUPPLY OR DISCLOSE ANY INFORMATION REGARDING THEM TO ANY UNAUTHORIZED PERSON.

Represented by: Interbank-Exchange, LLC  
P. O. Box 632  
Black Canyon City, AZ 85324

**Q-Tran-1019 Transaction Station**

Submitted By:  
**BRIAN COBLE**

Date:  
**1/7/2008**

Sheet:  
**QSP-713S MINI-1**