

LEFT SIDE VIEW

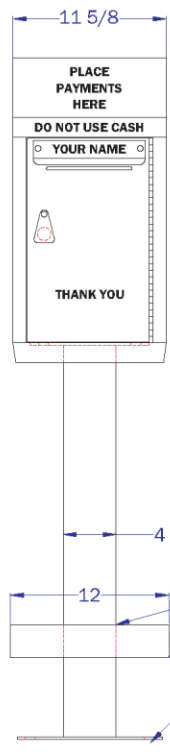

FRONT VIEW

SILICONE COVER PLATE  
AROUND PEDESTAL  
AFTER INSTALLED

LEVEL WITH SS  
WASHERS IF NEEDED

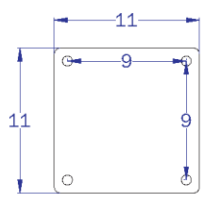

BASE PLATE  
FOOT PRINT

**AS-400-OC : INCLUDES**

PART ID	DESCRIPTION
0104	M400 Stainless Steel "fold-weld" cap and cabinet, piano hinged door, brass works lock, (2) double-bitted keys, strong cam, lock cover and floor liner, rainshield installed above slot and (3) black signs: "PLACE PAYMENTS HERE", "DO NOT USE CASH", "THANK YOU".
1002	ID Plate 1.25 x 8.5 inch wide, engraved with your name.
0306	30 inch Stainless Steel Platform Pedestal thick walled 4 x 4 inch SS post welded to heavy top and base plate with cover, includes (4) .5 inch SS carriage head fasteners for attaching pedestal to cabinet and (4) .5 inch SS wedge anchors for installation into concrete.

**ACCESSORY OPTIONS**

PART ID	DESCRIPTION
0601	Double Lock Door Panel with (2) eight tumbler, all brass works locks and (2) double-bitted keys for each lock.
0609	"CLOSED" Slot Cover attaches inside with (2) wing nuts.
0702	Wide-Slot Entry Panel .75 x 8.75 inches wide slot opening with heavy duty SS rainshield.
0801	Envelope Holder 8 x 4.5 inches wide [25 capacity]
0802	Envelope Holder 10.5 x 4.5 inches wide [25 capacity]
0803	Envelope Holder 10.5 x 4.5 inches wide [100 capacity]
1101	Ocean Front Finish powder coat salt resistant finish, for each cabinet, pedestal, or pair of protector posts.
1008	Custom Vinyl Message and/or Color
1102	Powder Coat entire cabinet One color.
1103	Custom Color Match please provide design or color swatch.

**30" PLATFORM PEDESTAL ANCHORS WITH (4) 1/2" SS ANCHORS**

1. MARK AND DRILL HOLE SAME SIZE AS ANCHOR
2. TAP IN ANCHOR
3. SECURE WITH WRENCH

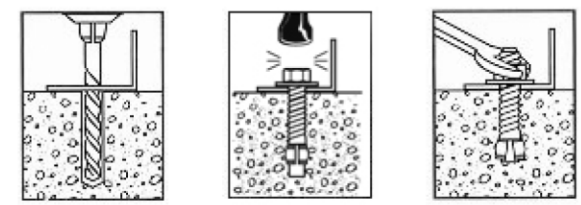

THE INFORMATION CONTAINED IN THIS DRAWING IS THE SOLE PROPERTY OF AMERICAN BOOK RETURNS. ANY MISUSE IN PART OR AS A WHOLE IS STRICTLY PROHIBITED BY AMERICAN BOOK RETURNS.



Represented by  
Black Canyon, AZ  
866-286-4400

**Interbank-Equipment**

TITLE **MODEL 400-OC WALK-UP ON-CONCRETE CUT SHEET**

PART NAME **M400-OC**

REV	DESCRIPTION	DATE	BY	TOL: UNLESS OTHERWISE SPECIFIED ANGLES: ±1°
	<b>RELEASE</b>	<b>04-19-10</b>	<b>JRS</b>	.XX±.030 .XXX±.010

SHEET	PART ID #	SCALE	REV
<b>1 OF 1</b>	<b>SEE ABOVE</b>	<b>NTS</b>	